

more **SPACE** place<sup>®</sup>

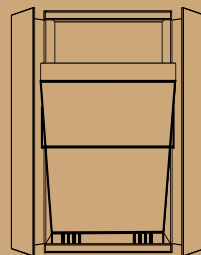

## murphy bed • panel bed planning guide

from comfortable bed to stylish  
space saver in one easy step



murphy bed style

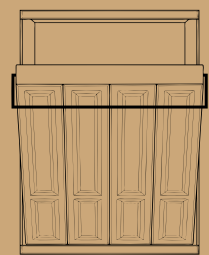

panel bed style

# murphy beds

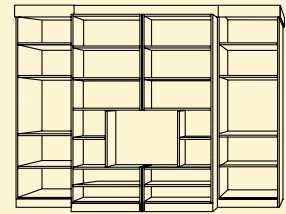
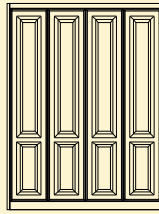
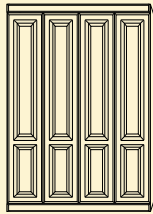

	murphy	pocket door bed	jefferson library bed
	This pull-down bed is hidden by attractive bi-fold doors when not in use. Custom designed for your space and style.	The time-tested Murphy bed mechanism with attractive hide-away bi-fold pocket doors that collapse into the bed cabinet sides.	Presidential indeed, with ample storage for books or collectibles. The bookcase doors effortlessly glide open on sturdy tracks.
style	murphy bed	murphy bed	murphy bed
doors	bi-fold doors	bi-fold pocket doors	tracked shelved doors
cabinets	side cabinets optional	side cabinets optional	30" side cabinets included
mattress	8 or 12 inches	8 or 12 inches	8 or 12 inches

dimensions & bed projection (bp): The space from the support wall that the mattress, panels or foundation projects into the room.

twin	45"w x 15"d x 85"h : 81"bp 45"w x 20"d x 85"h : 86"bp	–	–
twin long	45"w x 15"d x 90"h : 86"bp 45"w x 20"d x 90"h : 91"bp	–	–
full	60"w x 15"d x 85"h : 81"bp 60"w x 20"d x 85"h : 86"bp	69"w x 24"d x 85"h : 95"bp	121-3/4"w x 23-1/4"d x 87-5/8"h : 81"bp 121-3/4"w x 28-1/4"d x 87-5/8"h : 86" bp
queen	66"w x 15"d x 90"h : 86"bp 66"w x 20"d x 90"h : 91"bp	75"w x 24"d x 90"h : 95"bp	127-1/2"w x 15"d x 92 5/8"h: 86"bp 127-1/2"w x 20"d x 92 5/8"h: 91"bp
king	84"w x 15"d x 90"h : 86"bp 84"w x 20"d x 90"h : 91"bp	88-1/2"w x 26"d x 90"h : 95"bp	–

## murphy vs. panel

The **Murphy Bed** is a tried and true space saver. The spring loaded mechanism allows for easy single-handed operation and features a support leg that extends and retracts automatically. The Murphy bed's vertically stored mattress is either supported by our Comfort Flex Frame System (a series of pre-curved high strength wooden slats) or a Bunkie board (a cloth covered foundation). Each is designed to provide additional comfort and support for the mattress.

The **Panel Bed** maximizes space and offers a sleek, clutter-free design. These beds feature front panel doors that drop down with the bed and "disappear" under the mattress, allowing easy access to optional bedside cabinets. Each panel bed features one of two styles and includes spring loaded and cabinet-mounted bed mechanisms for effortless operation.



Dreamsaver Murphy Bed (open)

# murphy beds

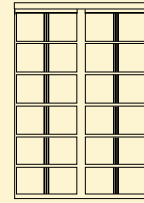
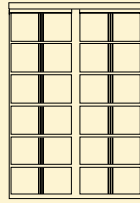
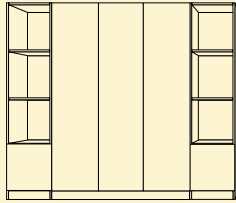

	<b>dreamsaver</b>	<b>madison bookcase bed</b>	<b>madison bi-fold bookcase bed</b>
	Stylish and affordable. This Murphy bed – equipped with included functional side cabinets – turns any area into a space savvy guest room.	Stylish bookcase or cozy sleeper? It's both. Swing open the shelved doors to reveal the pull down bed inside!	Unique. Similar in look to the Madison. Bi-folding doors take up less wall space when open.
style	murphy bed	murphy bed	murphy bed
doors	bi-fold doors	hinged shelved doors	hinged shelved doors
cabinets	–	side cabinets optional	side cabinets optional
mattress	7 inches	8 or 12 inches	8 or 12 inches

dimensions & bed projection (bp): The space from the support wall that the mattress, panels or foundation projects into the room.

twin	79-1/2"w x 16"d x 82"h : 82"bp	45"w x 23-1/8"d x 85"h : 81" or 86"bp 86-1/2"w with doors open	–
twin long	–	45"w x 23-1/8"d x 90"h : 86" or 91"bp 86-1/2"w with doors open	–
full	94-1/2"w x 16"d x 82"h : 82"bp	60"w x 23-1/8"d x 85"h : 81"bp 60"w x 28-1/8"d x 85"h : 86"bp 117"w with doors open	60"w x 23-1/8"d x 85"h : 81"bp 60"w x 28-1/8"d x 85"h : 86"bp 88"w with doors open
queen	100-1/2"w x 16"d x 87"h : 88"bp	66"w x 23-1/8"d x 90"h : 86"bp 66"w x 28-1/8"d x 90"h : 91"bp 123"w with doors open	66"w x 23-1/8"d x 90"h : 86"bp 66"w x 28-1/8"d x 90"h : 91"bp 97"w with doors open
king	–	–	–

## madison bookcase bed door options:

Choose from swinging doors or bi-fold doors to suit your space.

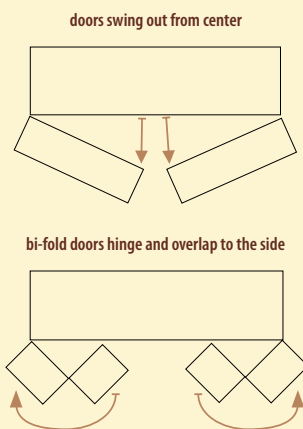

**Madison Bi-fold Bookcase Bed**  
(pictured with side cabinets)



**Madison Bi-fold Bookcase Bed**  
(pictured open with side cabinets)

# panel beds

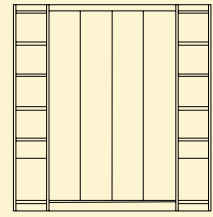
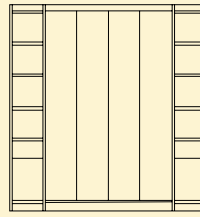
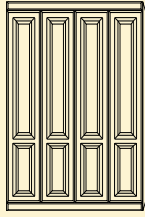

## metropolitan

## new yorker

## manhattan

The panel bed saves even more space without the bi-fold doors. The panel drops down with the bed to become its mattress support.

Strikingly contemporary, with 1-1/8" wide verticals and built in drop-down nightstands; a great statement in your space.

Contemporary and sophisticated; this bed features built in drop-down nightstands and inset doors.

style	panel bed	panel bed	panel bed
doors	solid panel door	solid panel door	solid panel door
cabinets	side cabinets optional	16" side cabinets included	16" side cabinets included
mattress	8 or 12 inches	8 inches	8 or 12 inches

dimensions & bed projection (bp): The space from the support wall that the mattress, panels or foundation project into the room.

twin	44-1/2"w x 15 3/4"d x 85"h : 85"bp 44-1/2"w x 20 7/8"d x 85"h : 90"bp	77-5/8"w x 15-3/4"d x 83"h : 85"bp	76-1/8"w x 15-3/4"d x 83"h : 85"bp
twin long	44-1/2"w x 15 3/4"d x 90"h : 90"bp 44-1/2"w x 20 7/8"d x 90"h : 95"bp	77-5/8"w x 15-3/4"d x 90"h : 90"bp	76-1/8"w x 15-3/4"d x 90"h : 90"bp
full	59-1/2"w x 15 3/4"d x 85"h : 85"bp 59-1/2"w x 20 7/8"d x 85"h : 90"bp	92-5/8"w x 15-3/4"d x 85"h : 85"bp	91-1/8"w x 15-3/4"d x 85"h : 85"bp
queen	65-1/2"w x 15 3/4"d x 90"h : 90"bp 65-1/2"w x 20 7/8"d x 90"h : 95"bp	98-3/4"w x 15-3/4"d x 90"h : 90"bp	97-1/4"w x 15-3/4"d x 90"h : 90"bp
king	-	-	-



**Metropolitan Panel Bed**  
(pictured closed with optional side cabinets)



**New Yorker** (closed)



**New Yorker** (open)

# panel beds



**Cosmopolitan** panel bed. Shown open above and closed below.



**Children's room** (Open panel bed, pictured above)

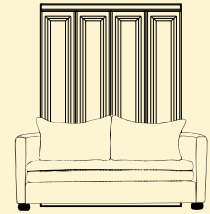
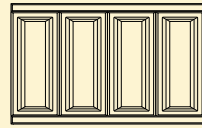

## cosmopolitan

Whether you have a low ceiling or love the contemporary look, this horizontal panel bed is the perfect solution.

## chesterfield

Extra seating converts easily to extra sleeping. Remove the cushions from this wall bed/sofa combo and the panel bed rests comfortably between the arms.

style	horizontal panel bed	metropolitan panel bed with sofa
doors	solid panel door	solid panel door
cabinets	side cabinets optional	side cabinets optional
mattress	8 inches	8 or 12 inches

dimensions & bed projection (bp): The space from the support wall that the mattress, panels or foundation projects into the room.

twin	80"w x 15 3/4"d x 49-1/4"h : 49"bp	—
twin long	85"w x 15 3/4"d x 49-1/4"h : 49"bp	—
full	80"w x 15 3/4"d x 64-1/2"h : 64"bp	59-1/2"w* x 15 3/4"d x 85"h : 85"bp 59-1/2"w* x 20 7/8"d x 85"h : 90"bp *Plus 8-12" for sofa arms
queen	85"w x 15 3/4"d x 70-1/2"h : 70"bp	65-1/2"w* x 15 3/4"d x 90"h : 90"bp 65-1/2"w* x 20 7/8"d x 90"h : 95"bp *Plus 8-12" for sofa arms
king	—	—

## chesterfield options:

These modified, lower cabinet configurations are designed to accommodate the sofa arms while maximizing storage. Available in 24" or 30" wide cabinets. Choose from a wide selection of designer cloths, microsuedes and faux leathers.

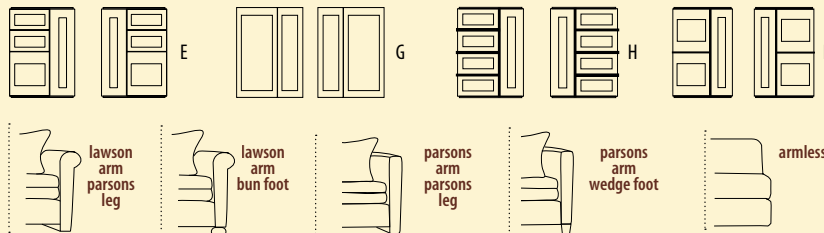

**Chesterfield Panel Bed** (pictured with optional side cabinets. Shown open above.)



Panel Bed with Home Office



Murphy Bed with Home Office

## ■ ■ ■ endless options

Customize your Murphy bed with these functional cabinet units in any of hundreds of style and finish combinations. Available in 85- or 90-inch heights, 12-, 15-, 20- or 24-inch depths, and 15-, 24-, 30- or 36-inch widths.



Rest assured our Serta® mattresses - specifically designed for vertical storage and manufactured for More Space Place - represent the pinnacle in sleep-time bliss. Options range from firm, plush euro-top, to cool action™ gel memory foam.

**Angle End**

Available sizes (WxD)  
15x15 & 20x20 inches

**Radius End**

Available sizes (WxD)  
15x15 & 20x20 inches

**Radius Shelf**

Available sizes (WxD)  
6x12 inches

85- or 90- inches high:

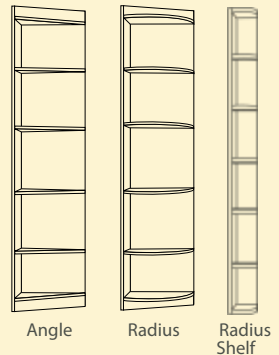

## Schedule a complimentary consultation today.

Visit us online to find a showroom near you: [www.morespaceplace.com](http://www.morespaceplace.com)

At More Space Place, we can uniquely customize and organize any space:

In your home...

- Closets
- Garages
- Media & Game Rooms
- Utility Rooms
- Bedrooms
- Hobby & Crafting Spaces
- Pantries
- Home Offices
- Kid's Rooms

Commercial Environment...

- Hotels
- Firehouses
- Sleep Centers
- Schools
- Dormitories
- Offices
- Medical Offices
- Supply Rooms

Ask for a More Space Place Home Office and Custom Cabinetry Guide...

for more information on our customizable space saving solutions and unbeatable selection.